

Vionaro H185 Inset Drawer System

Inset front panel and accessory set



- Color-coordinated aluminum front panel profile
- 185mm (7 1/4") side height
- Cubist design with 90° angles
- Slimline 13mm (1/2") side width
- Bottom panel is cut to size without notching

Vionaro H185 Inset Drawer and Accessory Set

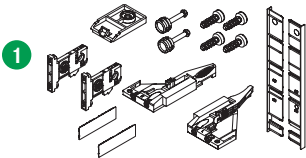

Description	Item No. White	Item No. Graphite	PU
H185 Inset Drawer Accessory Set	F136100320517	F136100319517	50

Accessory set consists of:

- 1a** 2 - Cover Caps
- 1d** 4 - Front Connector Screws
- 1g** 2 - Front Stabilizers with 8mm dowel
- 1b** 1 - Front Locking Device Set, left/right
- 1e** 1 - Front Bottom Connectors
- 1c** 2 - Front Connectors
- 1f** 2 - End caps

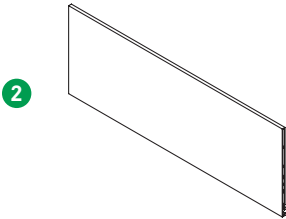

Description/Length	Item No. White	Item No. Graphite	PU
H185 Inset Front Panel			
1160 (45 11/16")	F136120589507	F136120539507	10

H185 inset front panels can be cut to length. One side is pre-drilled and a drilling template is provided for the other side for accurate installation. Assembly instructions for the accessory set are included with each panel.

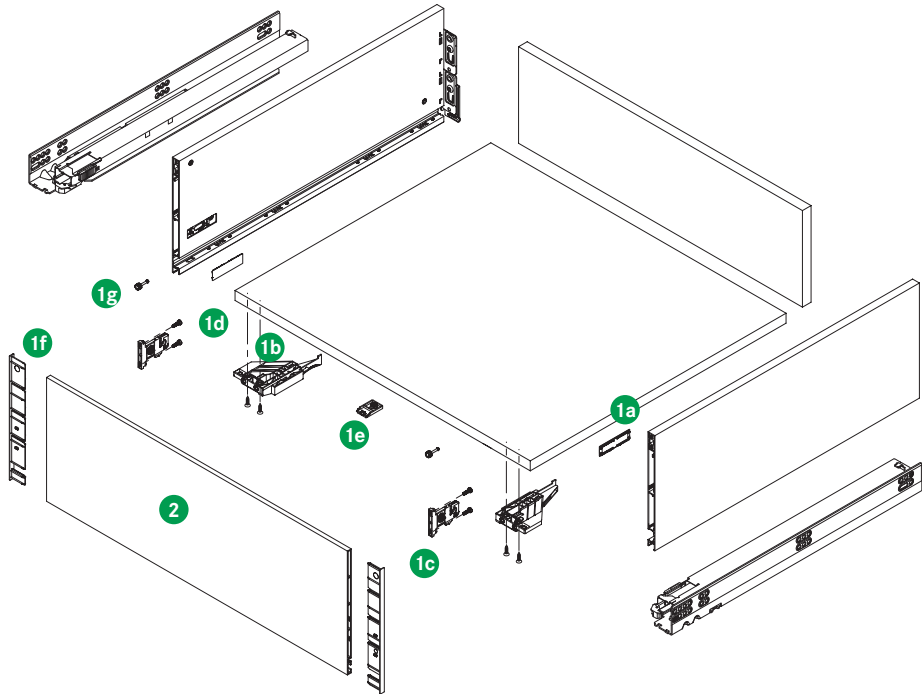

PU - Packaging unit

Drawer height	185mm (7 1/4")
Standard Dynamic Load	100 lb (45 kg)
HD Dynamic Load	132 lb (60 kg)
Static Load Standard/HD	100 lb (45 kg)/150 lb (70 kg)

Inset Drawer Back and Bottom Measurements

Front Locking Device Position and Installation

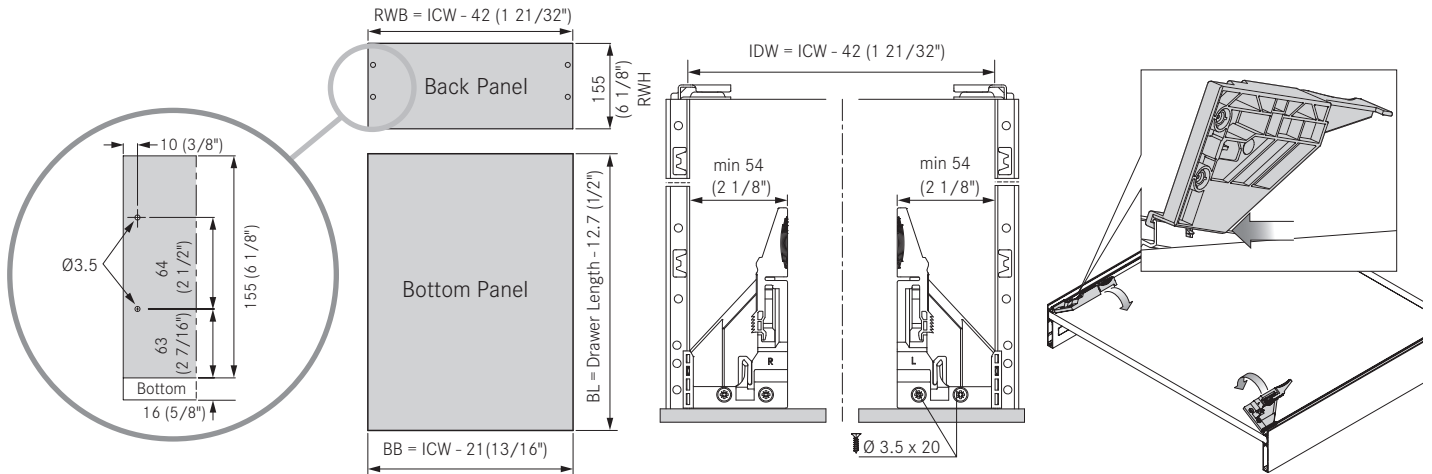

Front Panel Measurements

Drawer Measurements

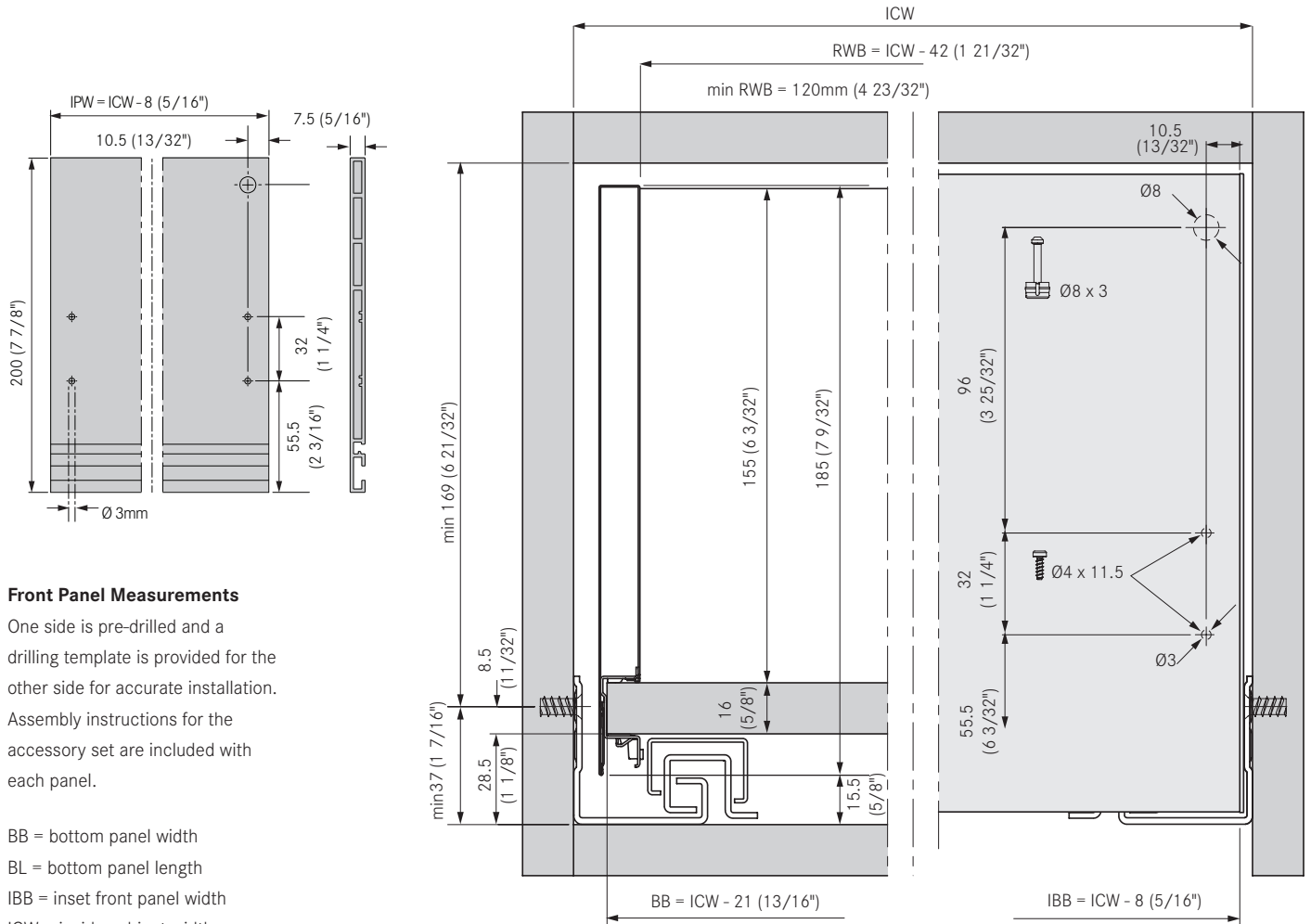

Front Panel Measurements

One side is pre-drilled and a drilling template is provided for the other side for accurate installation. Assembly instructions for the accessory set are included with each panel.

BB = bottom panel width

BL = bottom panel length

IBB = inset front panel width

ICW = inside cabinet width

IDW = inside drawer width

IPW = inside panel width

RWB = back panel width

RWH = back panel height